

189 N Fairview Ave
GOLETA, CA



For Lease | Retail Anchor in **Fairview Shopping Center** | 23,992 SF

Experience. Integrity. Trust.
Since 1993

Kristopher Roth
805.898.4361
kris@hayescommercial.com
lic. 01482732

Caitlin Hensel
805.898.4374
caitlin@hayescommercial.com
lic. 01893341



PROPERTY SUMMARY

Rare Big Box Anchor opportunity in the Fairview Shopping Center, the area's finest grocery-anchored neighborhood center bolstered by Sprouts, Michael's, Rite Aid and Miners Hardware. The subject offers prominent signage, high ceilings and rear access for loading. Other tenants include highly trafficked businesses such as Starbucks, Jersey Mike's, Chicken Ranch, Wells Fargo, U.S. Bank and more.

Size: 23,992 SF
Rate: \$2.35 NNN (.38)
Term: 10 years
Available: Now
Parking: 4/1,000 SF
To Show: Call listing agents



Experience. Integrity. Trust.
 Since 1993

Kristopher Roth
 805.898.4361
kris@hayescommercial.com
 lic. 01482732

Caitlin Hensel
 805.898.4374
caitlin@hayescommercial.com
 lic. 01893341





SB Airport

UCSB

Miner's
ACE
Hardware

SPROUTS
FARMERS MARKET

Michaels

RITE
AID

US
101

US
101

SITE

TRAFFIC COUNT

North Fairview Avenue (at Calle Real) **22,220 CPD**

DEMOGRAPHICS

	3 Mile	5 Mile	7 mile
Residential Population	66,775	96,990	136,200
Avg. Household Income	\$133,654	\$142,236	\$147,764

Experience. Integrity. Trust.
Since 1993

Kristopher Roth
805.898.4361
kris@hayescommercial.com
lic. 01482732

Caitlin Hensel
805.898.4374
caitlin@hayescommercial.com
lic. 01893341



FLOOR PLAN

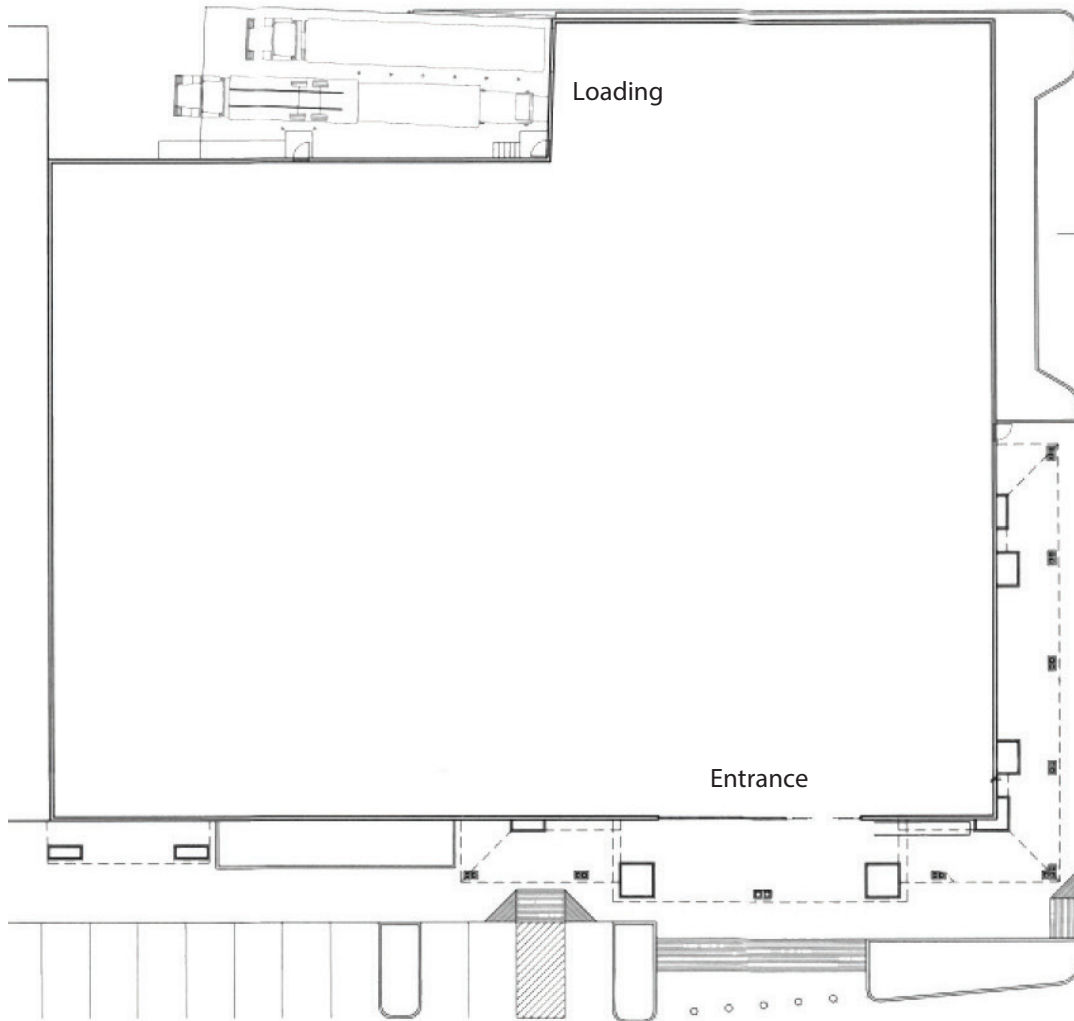

Experience. Integrity. Trust.
Since 1993

Kristopher Roth
805.898.4361
kris@hayescommercial.com
lic. 01482732

Caitlin Hensel
805.898.4374
caitlin@hayescommercial.com
lic. 01893341



FAIRVIEW SHOPPING CENTER



Experience. Integrity. Trust.
Since 1993

Kristopher Roth
805.898.4361
kris@hayescommercial.com
lic. 01482732

Caitlin Hensel
805.898.4374
caitlin@hayescommercial.com
lic. 01893341

